

TOSHIBA

Setting Up Presets For Dept. Codes on Mac Computers

First make sure you have installed the latest Mac driver from www.HelpOnline123.com

In your print job Go To: [FILE] then [PRINT], this will pull up the print dialog box

Go To: [LAYOUT]

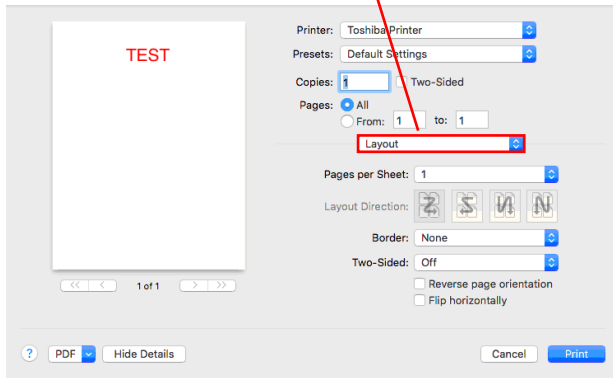

Select: [PRINT MODE]

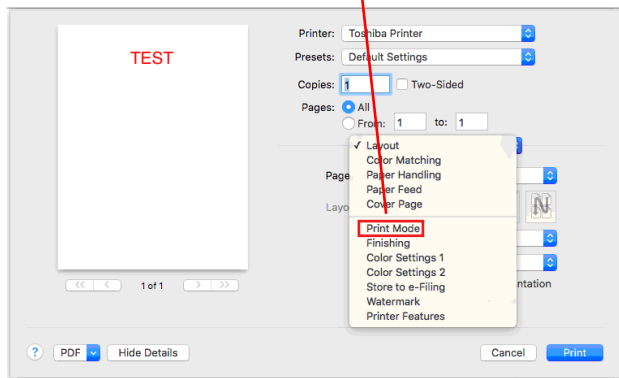

Enter Your Dept. Code & Press the Arrow

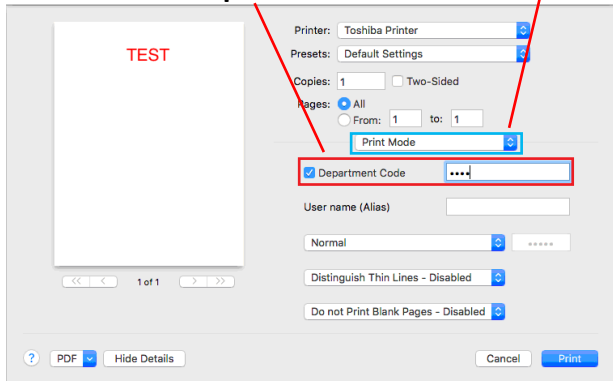

Go To: [COLOR SETTING 1]

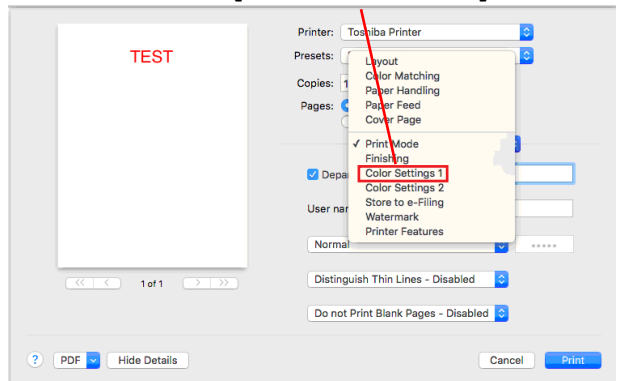

Make Your Selection, Go To: [PRESETS]

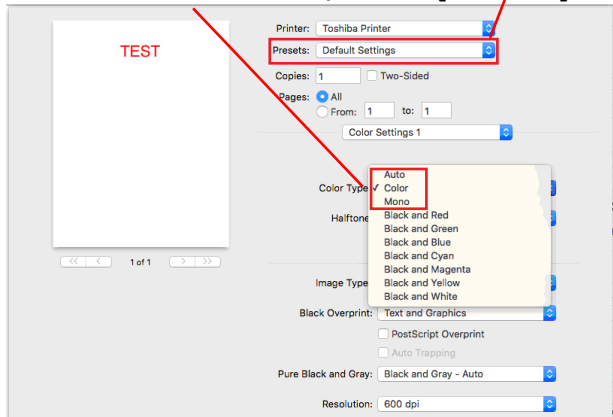

Select: [SAVE CURRENT SETTINGS AS PRESET]

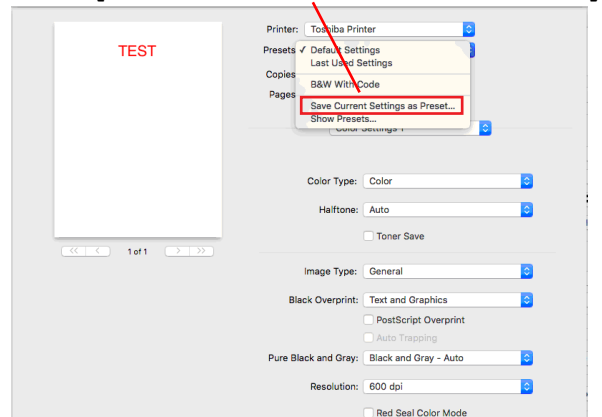

TOSHIBA

Name Your Preset (Toshiba Color / Toshiba B&W, Your Choice) Press: [OK]

TE

Preset Name: Toshiba Color Print

Preset Available For: Only this printer
 All printers

Cancel OK

Color Settings 1

Color Type: Color

Halftone: Auto

Toner Save

Image Type: General

Black Overprint: Text and Graphics

PostScript Overprint
 Auto Trapping

Pure Black and Gray: Black and Gray - Auto

Resolution: 600 dpi

Red Seal Color Mode

Keep adding Presets as you feel the need and remember to select the Department Code for each preset you want to create.

THIS DOCUMENT IS PROVIDED BY THE **TOSHIBA** HELPDESK